

**FB01 (Floor Beam)**

BC CALC® Member Report  
 Build 7555  
 Job name:  
 Address:  
 City, State, Zip:  
 Customer:  
 Code reports: ESR-1040

Dry | 1 span | No cant.

March 7, 2020 12:42:46

File name:  
 Description:  
 Specifier:  
 Designer: B F  
 Company: WE

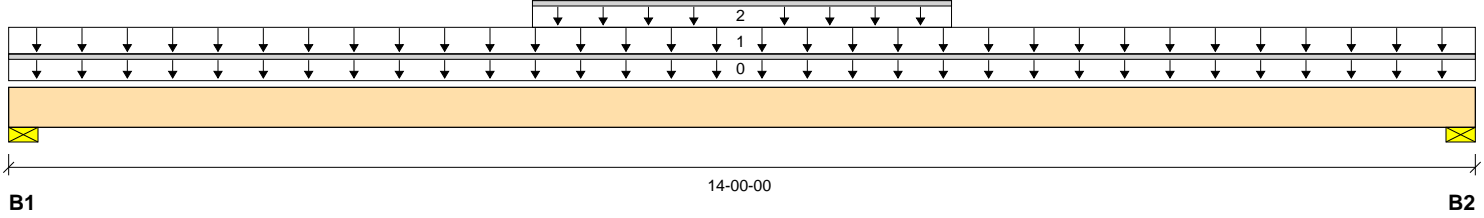

Total Horizontal Product Length = 14-00-00

**Reaction Summary (Down / Uplift) (lbs)**

Bearing	Live	Dead	Snow	Wind	Roof Live
B1, 3-1/2"	3640 / 0	1500 / 0			
B2, 3-1/2"	3640 / 0	1500 / 0			

**Load Summary**

Tag	Description	Load Type	Ref.	Start	End	Loc.	100%	90%	115%	160%	Roof Live	Tributary
0	Self-Weight	Unf. Lin. (lb/ft)	L	00-00-00	14-00-00	Top		13				00-00-00
1	1st floor	Unf. Area (lb/ft²)	L	00-00-00	14-00-00	Top	40	10				13-00-00
2	island	Unf. Lin. (lb/ft)	L	05-00-00	09-00-00	Top		250				n/a

**Controls Summary**

	Value	% Allowable	Duration	Case	Location
Pos. Moment	18078 ft-lbs	95.6%	100%	1	07-00-00
End Shear	4422 lbs	46.7%	100%	1	01-01-00
Total Load Deflection	L/208 (0.783")	115.6%	n/a	1	07-00-00
Live Load Deflection	L/310 (0.524")	116.2%	n/a	2	07-00-00
Max Defl.	0.783"	78.3%	n/a	1	07-00-00
Span / Depth	17.1				

**Bearing Supports**

	Dim. (LxW)	Value	% Allow Support	% Allow Member	Material
B1	Wall/Plate 3-1/2" x 5-1/4"	5140 lbs	n/a	37.3%	Unspecified
B2	Wall/Plate 3-1/2" x 5-1/4"	5140 lbs	n/a	37.3%	Unspecified

**Cautions**

Member is insufficient to carry loads for Code minimum Total load deflection at limit of L/240.  
 Member is insufficient to carry loads for Code minimum Live load deflection at limit of L/360.

**Notes**

Design meets arbitrary (1") Maximum Total load deflection criteria.  
 Calculations assume member is fully braced.  
 BC CALC® analysis is based on IBC 2009.  
 Design based on Dry Service Condition.

**FB01 (Floor Beam)**

Dry | 1 span | No cant.

March 7, 2020 12:42:46

BC CALC® Member Report

Build 7555

Job name:

File name:

Address:

Description:

City, State, Zip:

Specifier:

Customer:

Designer: B F

Code reports: ESR-1040

Company: WE

**Connection Diagram: Full Length of Member**

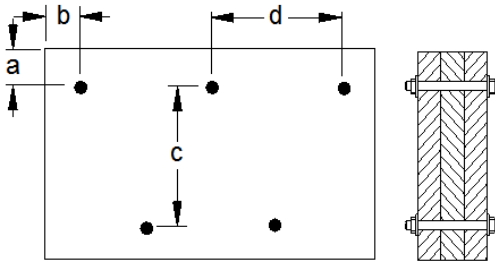

a minimum = 2"      c = 5-1/2"  
 b minimum = 2-1/2"      d = 24"

Bolts are assumed to be Grade A307 or Grade 2 or higher.  
 Connectors are: 1/2 in. Staggered Through Bolt

**Disclosure**

Use of the Boise Cascade Software is subject to the terms of the End User License Agreement (EULA). Completeness and accuracy of input must be reviewed and verified by a qualified engineer or other appropriate expert to assure its adequacy, prior to anyone relying on such output as evidence of suitability for a particular application. The output here is based on building code-accepted design properties and analysis methods. Installation of Boise Cascade engineered wood products must be in accordance with current Installation Guide and applicable building codes. To obtain Installation Guide or ask questions, please call (800)232-0788 before installation.

BC CALC®, BC FRAMER®, AJST™, ALLJOIST®, BC RIM BOARD™, BCI®, BOISE GLULAM™, BC FloorValue®, VERSA-LAM®, VERSA-RIM PLUS®,