

2009 Jaguar XF (X250) V8-4.2L

Vehicle > Accessories and Optional Equipment > Antitheft and Alarm Systems > Keyless Entry > Keyless Entry Transmitter > Keyless Entry Transmitter Battery > Technical Service Bulletins

KEYLESS SYSTEMS - ERRATIC SMART KEY(R) OPERATION

NUMBER JTB00075
(ISSUE 2)

MODEL
[NEW] XF [END NEW]
XK

DATE 29 JUNE 2009

ISSUE "2" CHANGES ARE HIGHLIGHTED WITH GRAY BACKGROUND, ALSO SHOWN WITH [NEW].

SECTION: 418

'Smart Key Battery Low' Displayed / Intermittent Remote Handset Operation Repair Procedure

XF (X250)	VIN: R00001 – R53809 Model Year: 2009 - 2010
XK (X150)	VIN: B12815 – B34241 Model Year: 2007 - 2009

AFFECTED VEHICLE RANGE

CONDITION SUMMARY:

Situation:

An issue has been identified where the Instrument Cluster information center displays the "Smart Key Battery Low" message or the Smart Key multi-channel remote handset operates intermittently. This may be caused by movement between the Smart Key battery and its contact.

Action:

Should a customer express the above concern, refer to the Repair Procedure outlined below to install a new Smart Key lower housing and battery.

 **NOTE:** Refer to Parts ALERT JA09PA-09 to ensure dealer stock of Smart Key lower housings have been inspected.

C2P 17158Smart Key lower housing (including battery) Qty: 1

PARTS

TOOLS:

No special tools required

Description	SRO	Time (hours)	Condition Code	Causal Part
Smart Key lower housing – Renew	86.93.87	0.20	42	C2P 17158

Normal warranty policy and procedures apply.

WARRANTY:

NOTE:

Repair procedures are under constant review, and therefore times are subject to change; those quoted here must be taken as guidance only. Always refer to DDW to obtain the latest repair time.

DDW requires the use of causal part numbers. Labor only claims must show the causal part number with a quantity of zero.

REPAIR PROCEDURE

REPLACING THE SMART KEY LOWER HOUSING AND BATTERY

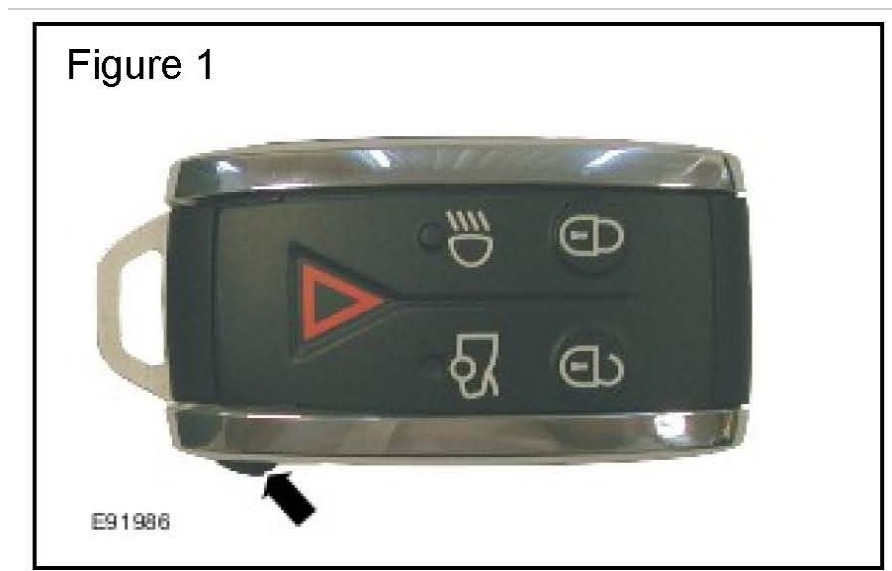

1. Remove the Smart Key blade by pressing the clip. (Figure 1)

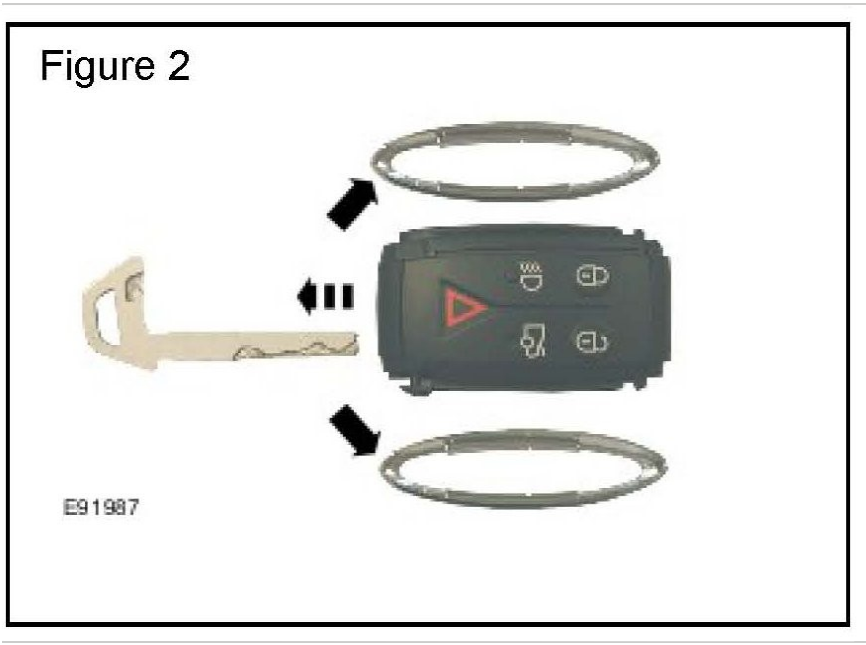

2. Insert a small, flat-blade screwdriver between the cover and the body and lightly twist the screwdriver to remove both side chrome rings one at a time. (Figure 2)

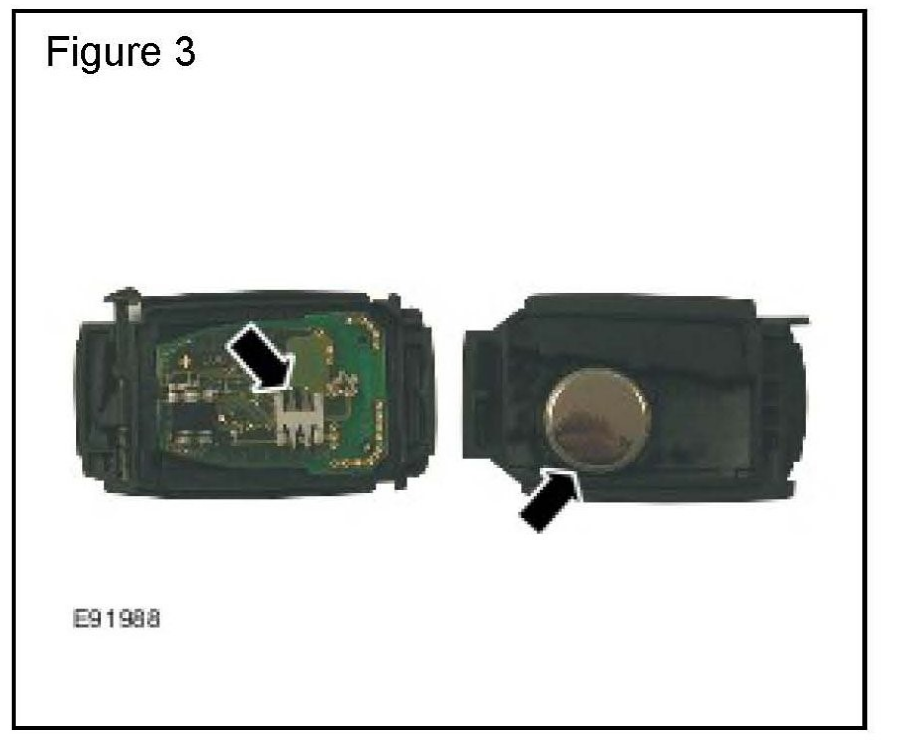

CAUTION:
Do NOT touch the green printed circuit board, battery, or the battery contacts. Oil or any other contamination on either component can affect the Smart Key performance. (Figure 3)

3. Pull apart the Smart Key and discard the lower housing and battery properly.