

1989 Mercedes Benz 560SL (107.048) V8-5.6L (117.967)

Vehicle > Powertrain Management > Fuel Delivery and Air Induction > Fuel Pump > Fuel Pump Relay > Description and Operation > Components

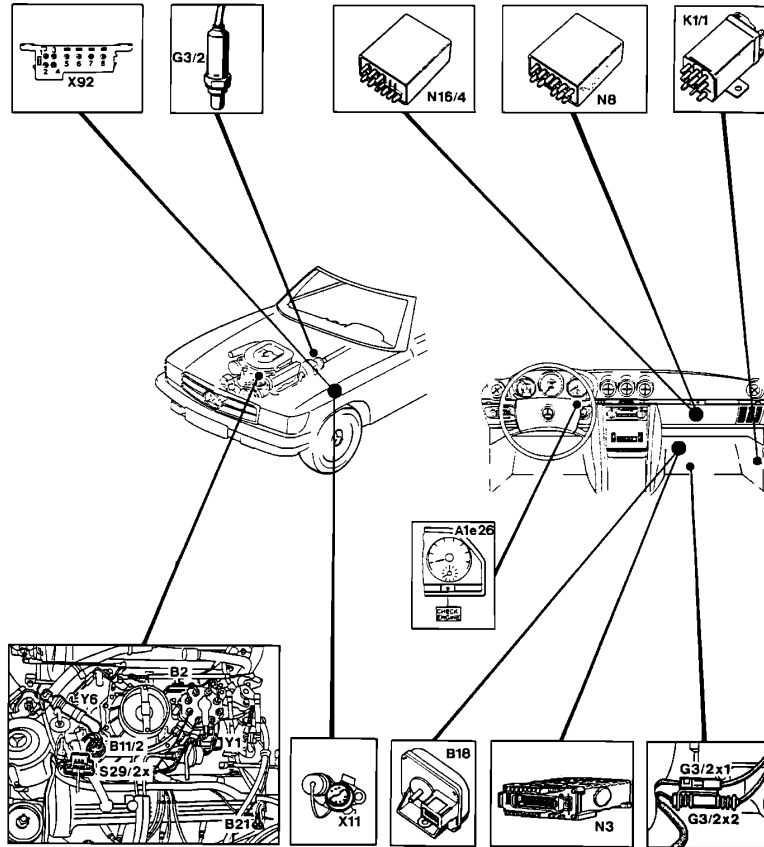

- | | | | |
|---------|---|---------|--|
| A 1 e26 | "CHECK ENGINE" warning lamp | N 3 | CIS-E control unit |
| B 2 | "Air flow sensor position indicator | N 8 | Idle speed control unit |
| B 11/2 | Coolant temperature sensor | N 16/4 | Fuel pump relay (with starting valve control, kick-down cutout and rpm limiting) |
| B 18 | Altitude correction capsule | S 29/2x | Connector, throttle valve switch |
| B 21 | Exhaust gas recirculation temperature sensor | X 11 | Diagnostic socket/terminal block (circuit TD) |
| G 3/2 | Heated O ₂ -sensor | X 92 | Test connection for diagnosis (8-pole, impulse readout) |
| G 3/2x1 | Connection, O ₂ -sensor heating filament | Y 1 | Electrohydraulic actuator (EHA) |
| G 3/2x2 | Connection, O ₂ -sensor signal | Y 6 | Idle speed air valve |
| K 1/1 | Overvoltage protection relay (California) | | |
| K 1 | Overvoltage protection relay (Federal) | | |