

SHOP • G 2.7 DOHC • Automatic Transaxle System (Automatic Transaxle) • Automatic Transaxle Control System • Shift Lever • Repair procedures (F4A51-3)

[Report a problem with this article](#)

REMOVAL

1. Remove the shift lever knob(A).

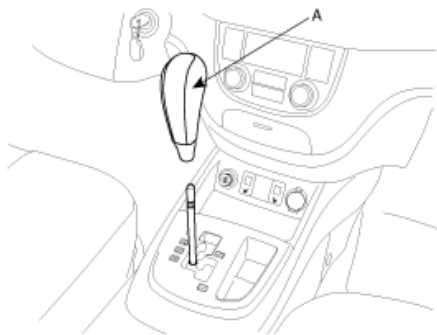

2. Remove the center console cover (A).



3. Remove the center console by removing the two screws (A) and the four bolts (B). (See BD group)

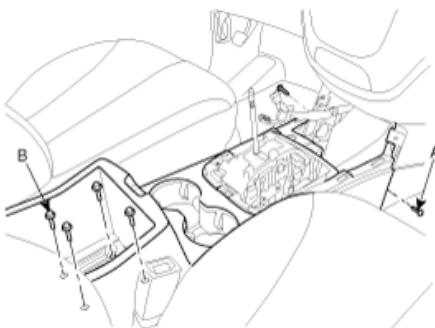

4. Disconnect the interlock switch connector (A).

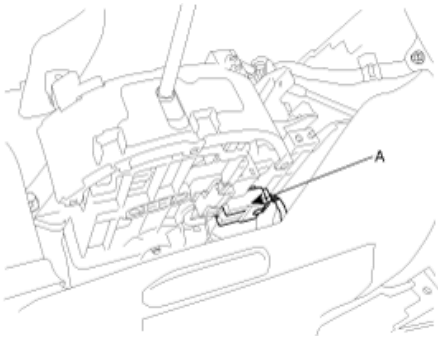

5. Remove the control cable assembly(C) by removing the snap pin (A) and the clip (B).

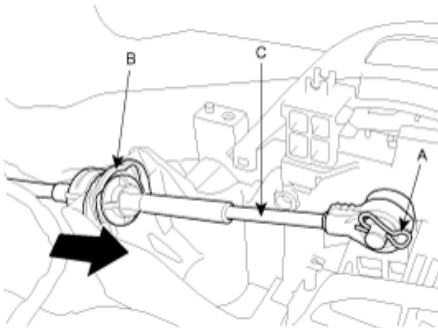

6. Remove the shift lever bolts (A-4ea).

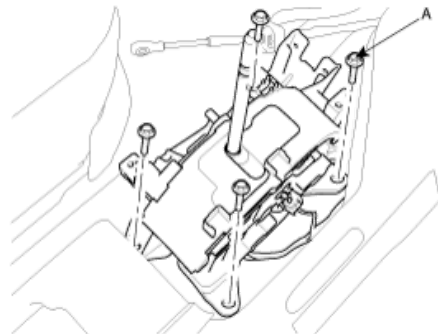

7. Remove the shift lever assembly.

INSTALLATION

1. Install the shift lever bolts (A-4ea).

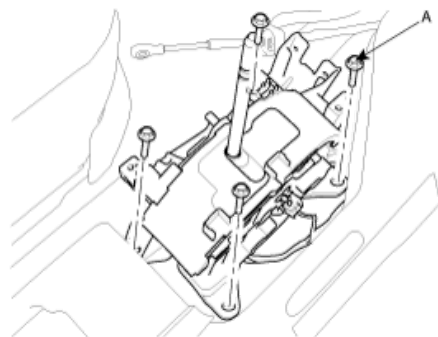

2. Install the control cable assembly (C) by inserting the snap pin (A) and the clip (B).

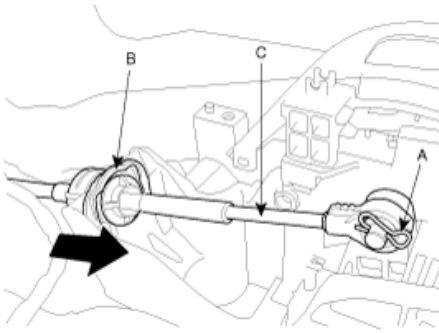

3. Connect the interlock switch connector (A).

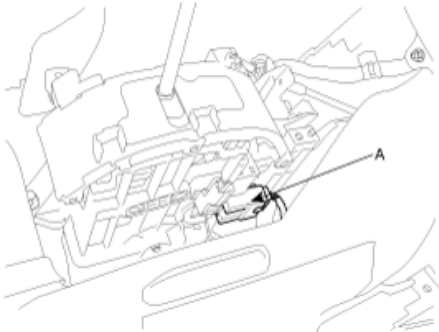

4. Install the center console by installing the two screws (A) and the four bolts (B). (See BD group)

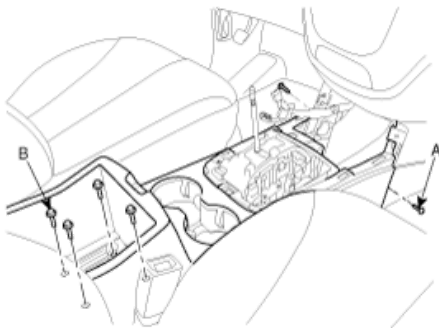

5. Install the center console cover (A).



6. Install the shift lever knob(A).

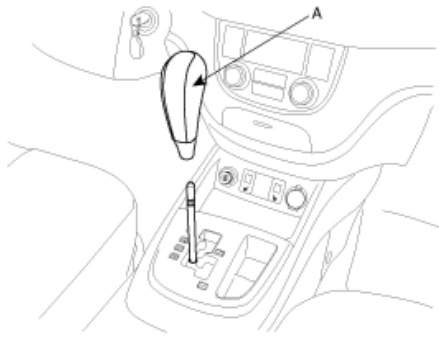

INSPECTION

Adjusting method for the control cable

1. Set room side lever and T/M side lever (A) to "N" position.
2. Connect the room side lever and shift cable. (See shift lever's "Installation")
3. Connect the T/M side lever (A) to cable (B) in this following order.
 - 1) Push the cable (B) lightly to "F" direction shown to eliminate FREE PLAY of the cable (B).
 - 2) Tighten the adjusting nut(C).

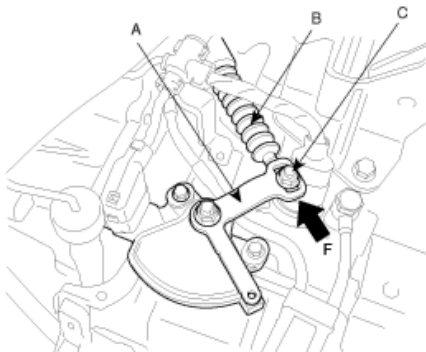

4. After adjusting the cable (B) according to (2)-(4), check to be sure that this part operates surely at each range of T/M side corresponding to each position of room lever.