

651381
245 (PRIOR TO 9A349239) TRACTOR

TRANSMISSION

153

2518 062

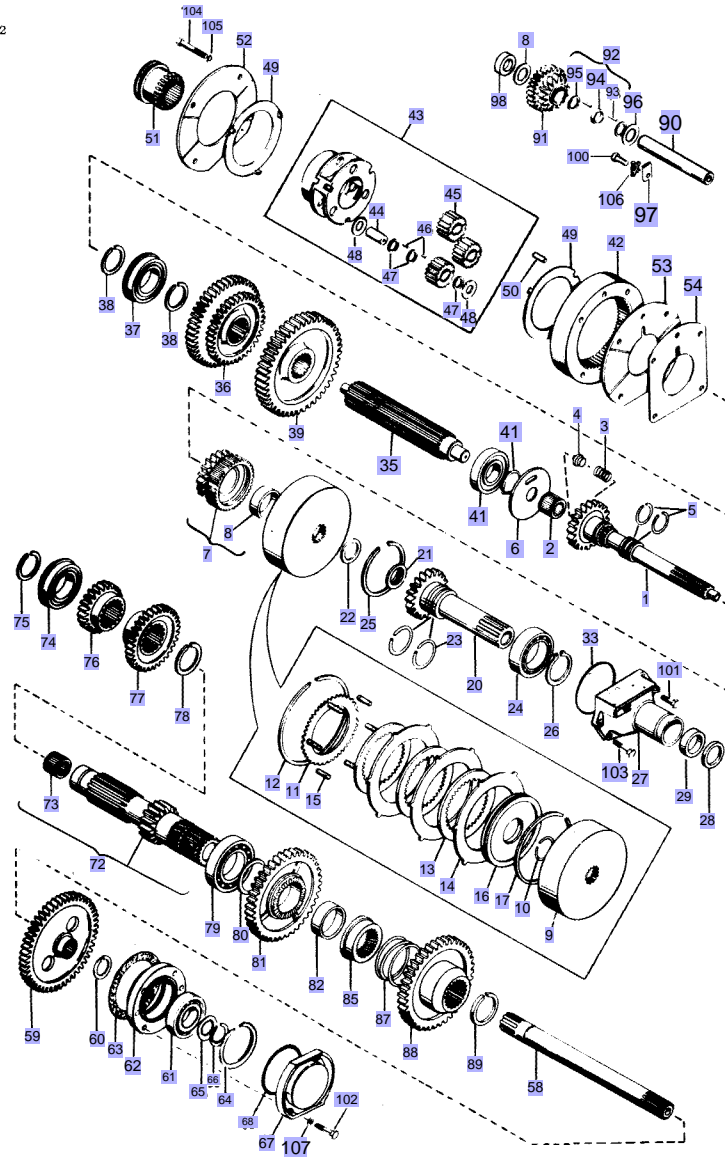

1st Print

651 381 M95 (ISSUE 1) 1/85

651381
245 (PRIOR TO 9A349239) TRACTOR

153
TRANSMISSION (MULTI-POWER)

Item	Part Number	Description	Qty	Tech Spec	Notes	Ref
1	1865766M91	SHAFT ASSEMBLY, MAIN INPUT SHAFT	1			
2	834844M1	BEARING, NEEDLE	1			
3	886352M1	SPRING, INPUT SHAFT	1			
4	886353M1	ABUTMENT, INPUT SHAFT	1			
5	186581M1	RING (1-1/2" O.D. X 3/32")	2			
6	190839M2	SPACER, INPUT SHAFT	1			
7	190827M91	PINION ASSY (19 DRIVE)	1			
8	188806M1	BUSHING (1-3/4 X 1-7/8 X 59/64")	1			
9	518508M93	HOUSING ASSEMBLY, CLUTCH	1			
10	1872134M92	VALVE ASSEMBLY, CHECK	1			
10		(NOT ILLUSTRATED)	1			
10	186580M1	RING (2-3/8" O.D. X 3/32")	1			
11	518507M1	PLATE, CLUTCH RETAINING	1			
12	364689X1	RING, INT. SNAP (5-3/4" O.D. X 1/4" THK.)	1			
13	190177M1	DISC, FRICTION	3			
14	185464M1	PLATE, CLUTCH	3			
15	186519M1	SPRING, PISTON RETURN	6			
16	186531M2	PISTON, CLUTCH	1			
17	185425M1	RING (5-11/32" O.D. X 1/8")	1			
20	1868528M92	PINION ASSEMBLY, MAIN (17 TEETH, 25 SPLINES)	1			
21	883935M4	SEAL, OIL (1-1/8 X 1-1/2 X 1/4")	1			
22	187074M1	WASHER (2-5/16" O.D. X 1/32")	1			
23	186198M1	RING, SEALING (2" O.D. X 3/32")	2			
24	833646M1	BEARING, BALL	1			
25	358890X1	RING, INT. SNAP (3-11/16" O.D. X 5/64" THK.)	1			
26	762101M1	RING, EXT. SNAP (1-31/32" I.D. X 1/16" THK.)	1			
27	1860889M91	RETAINER ASSEMBLY, MAIN DRIVE SHAFT	1			
28	1860867M3	SEAL, OIL (1-5/8 X 1-15/16 X 15/64")	1			
29	886668M1	BEARING, NEEDLE	1			
33	886089M1	"O" RING (4" I.D. X 5/64")	1			
35	1682542M1	SHAFT, MAIN (NORMAL DUTY)(12-17/32" LONG)	1			
36	880957M1	GEAR (2ND AND HIGH)(36 AND 46 TEETH, 18 SPLINES)	1			
37	195493M1	BEARING, BALL	1			
38	195363M1	RING, EXT. SNAP (1-53/64" I.D. X 3/32" THK.)	2			
39	1682688M1	GEAR (1ST)(44 TEETH, 18 SPLINES)	1			
40	831469M1	BEARING (1-37/64 X 3-9/64 X 45/64")	1			
41	352972X1	RING, EXT. SNAP (1-7/16" I.D. X 1/16" THK.)	1			
42	1865528M1	GEAR (54 TEETH, 1-23/32" WIDE)	1			
43	897711M92	CARRIER ASSEMBLY, PLANETARY	1			
44	897019M1	SHAFT (53/64 X 1-19/32")	3			
45	897018M1	PINION (18 TEETH, 1.0527" BORE)	3			
46	897025M1	ROLLER (7/64 X 7/16")	162			
47	897020M1	WASHER (27/32 X 1-3/64 X 1/16")	9			
48	184750M2	WASHER (27/32 X 1-3/8 X 1/32")	6			
49	897367M1	WASHER (4-1/8 X 5 X 1/16")	2			
50	180409M1	PIN (3/8 X 1-1/8" DOWEL)	2			
51	184770M2	COUPLER (2-1/16" LONG)	1			
52	184012M4	PLATE, COVER (REAR)	1			
53	180408M2	PLATE, COVER (FRONT)	1			
54	184011M1	SHIM, PLANETARY (.017" THK.)	1			
58	1868533M1	SHAFT, FRONT P.T.O. (21 SPLINES 16")	1			

651381
245 (PRIOR TO 9A349239) TRACTOR

153
TRANSMISSION (MULTI-POWER)

Item	Part Number	Description	Qty	Tech Spec	Notes	Ref
59	1868532M1	GEAR (53 TEETH, 21 SPLINES)(1 SPD. P.T.O.)	1			
60	358913X1	RING, INT. SNAP (1-31/64" O.D. X 3/64" THK.)	1			
61	899377M2	BEARING, BALL	1			
62	899331M1	HOUSING, P.T.O. DRIVE SHAFT BEARING	1			
63	180432M1	GASKET, SEALING	1			
64	355988X1	RING, INT. SNAP (3/32" THK.)	1			
65	881122M2	RING, RETAINING (1-1/8 X 1-9/16 X 5/64")	1			
66	208505M1	RING, EXT. SNAP (1-3/64" I.D. X 3/64" THK.)	1			
67	883620M1	CAP, BEARING HOUSING	1			
68	1004633M1	"O" RING (3-1/4" I.D. X 1/8")	1			
72	189391M92	COUNTERSHAFT ASSEMBLY	1			
73	195453M1	BEARING, INNER (NEEDLE)	1			
74	832519M1	BEARING, BALL	1			
75	195363M1	RING, EXT. SNAP (1-53/64" I.D. X 3/32" THK.)	1			
76	180419M1	GEAR (23 TEETH)	1			
77	180415M1	GEAR (33 TEETH)	1			
78	195500M1	RING, SNAP (2-1/6" I.D. X 7/64" THK.)	1			
79	195507M1	BEARING, BALL	1			
80	188859M1	WASHER (2-9/64 X 2-3/4 X 1/16")	1			
81	190829M91	GEAR ASSEMBLY (44 TEETH)	1			
82	832491M1	BUSHING (2-7/64 X 2-1/4 X 7/8")	1			
85	188834M2	COUPLER, CLUTCH	1			
87	188803M1	SPRING, CLUTCH JAW	1			
88	190831M1	GEAR (40 TEETH)	1			
89	831581M1	RING, EXT. SNAP (1-13/16" I.D. X 1/8" THK.)	1			
90	180445M1	SHAFT, REVERSE CLUSTER	1			
91	183040M1	GEAR, REVERSE CLUSTER (21 AND 13 TEETH)	1			
92	830735M91	KIT, BEARING	1			
93	183039M1	ROLLER (1/8 X 3/4")(18 PER PATH)	56			
94	183038M1	SPACER (1-1/64 X 1-13/64 X 7/32")	1			
95	183037M1	RETAINER (1-1/64 X 1-13/16 X 1/16")	2			
96	180458M1	WASHER (1 X 1-5/8 X 1/16")	2			
97	184789M1	STOP, REVERSE SHAFT	1			
98	189449M1	SPACER (1 X 5/8 X 5/16")	1			
100	353690X1	BOLT (3/8 X 7/8" NC, HEX.)	AR			
101	353692X1	BOLT (3/8 X 1-1/8" NC, HEX.)	AR			
102	353693X1	BOLT (3/8 X 1-1/4" NC, HEX.)	AR			
103	354265X1	BOLT (3/8 X 1-7/8" NC, HEX.)	AR			
104	354271X1	BOLT (3/8 X 2-3/4" NC, HEX.)	AR			
105	353434X1	WASHER (3/8" LOCK)	AR			
106	828020M1	WASHER (3/8" TAB SPECIAL)	AR			
107	353771X1	WASHER (13/32 X 13/16 X 3/32" FLAT)	AR			